

# ANGLE FITTINGS

**F33 4 Hole Gusset Plate**

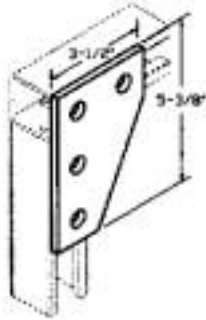

**F37 4 Hole Half Tee Plate**

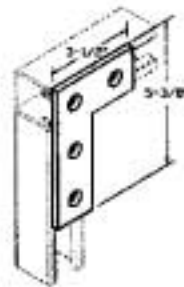

**F34 5 Hole Gusset Plate**

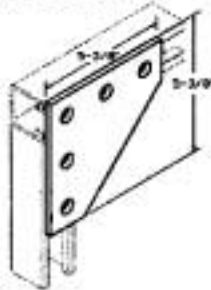

**F38 7 Hole Gusset Plate**

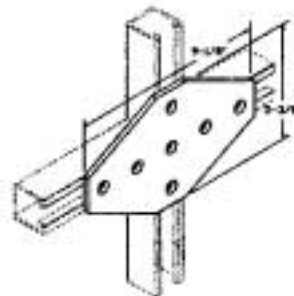

**F35 3 Hole Gusset Plate**

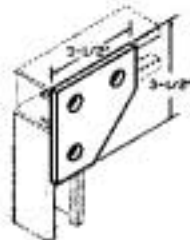

**L10 2 Hole Corner Angle**

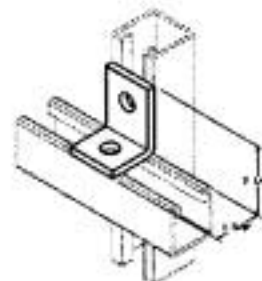

**F36 3 Hole Half Tee Plate**

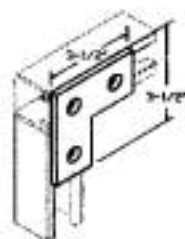

**L11 2 Hole Corner Angle**

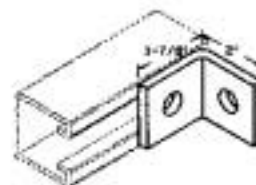

Fitting Specifications (unless noted):

Holes Sizes - 9/16", Spacing 13/16" from edge and 1-7/8" on center.  
Width - 1-5/8", Thickness 1/4", Standard Finish: EG.

# ANGLE FITTINGS

**L12 2 Hole Corner Angle**

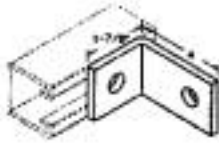

May be ordered with 'A' dimension of 3", 3-1/2" or 4".

**L13 Tapped 2 Hole Corner Angle**

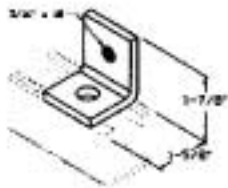

**L14 1 Stud - 1 Hole Angle**

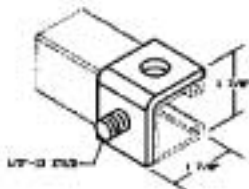

**L15 1 Slot - 1 Hole Angle**

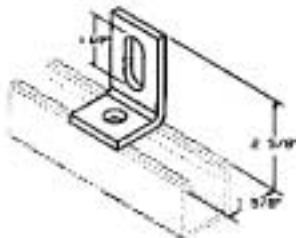

**L16, L17 1 Slot - 1 Hole Angle**

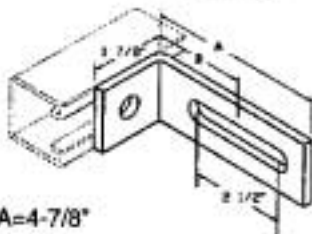

L16 - A=4-7/8"  
L17 - A=6-7/8"

**L18 3 Hole Corner Angle**

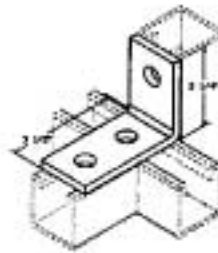

**L19 3 Hole Corner Angle**

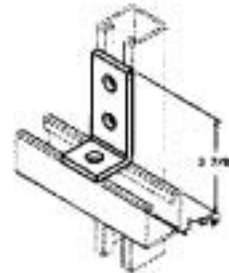

**L20 3 Hole Corner Angle**

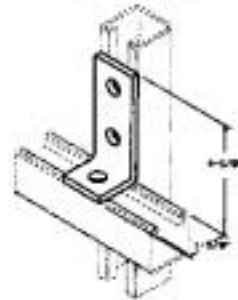

**L21 1 Slot - 2 Hole Corner Angle**

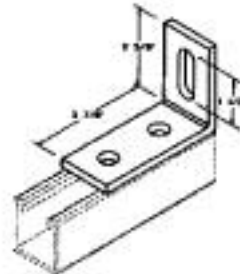

Fitting Specifications (unless noted):

Holes Sizes - 9/16", Spacing 13/16" from edge and 1-7/8" on center.  
Width - 1-5/8", Thickness 1/4"; EG Finish, Standard Finish: EG.

# ANGLE FITTINGS

**L22 4 Hole Corner Angle**

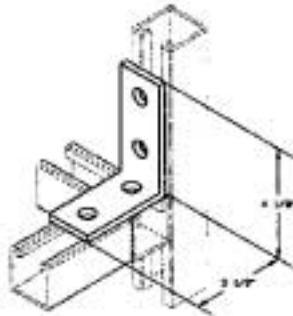

**L25 4 Hole Offset Corner Angle**

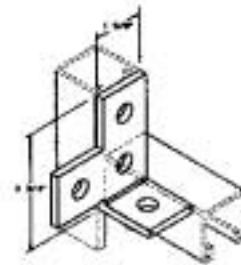

Available for right or left hand use (right hand shown).  
Specify 'R' or 'L' when ordering.

**L23 7 Hole Corner Angle**

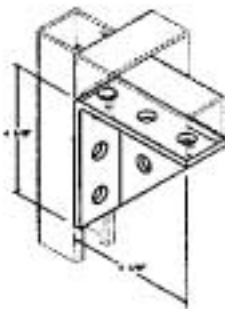

Universal style shown.  
Available also in right or left hand style, contact the  
factory.

**L26 3 Hole Offset Corner Angle**

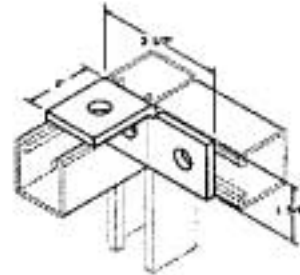

Available for right or left hand use (right hand shown).  
Specify 'R' or 'L' when ordering.

**L24 6 Hole Corner Angle**

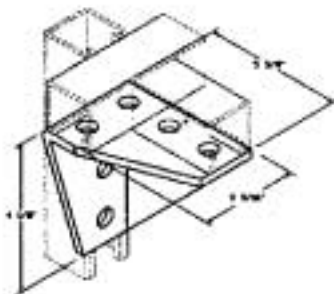

Available for right or left hand use (right hand shown).  
Specify 'R' or 'L' when ordering.

**L27 4 Hole Offset Corner Angle**

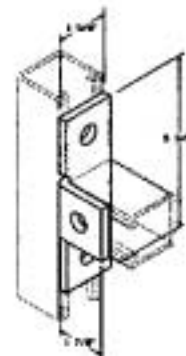

Fitting Specifications (unless noted):

Holes Sizes - 9/16", Spacing 13/16" from edge and 1-7/8" on center.  
Width - 1-5/8", Thickness 1/4", Standard Finish: EG.